

289-204
Vacant Land

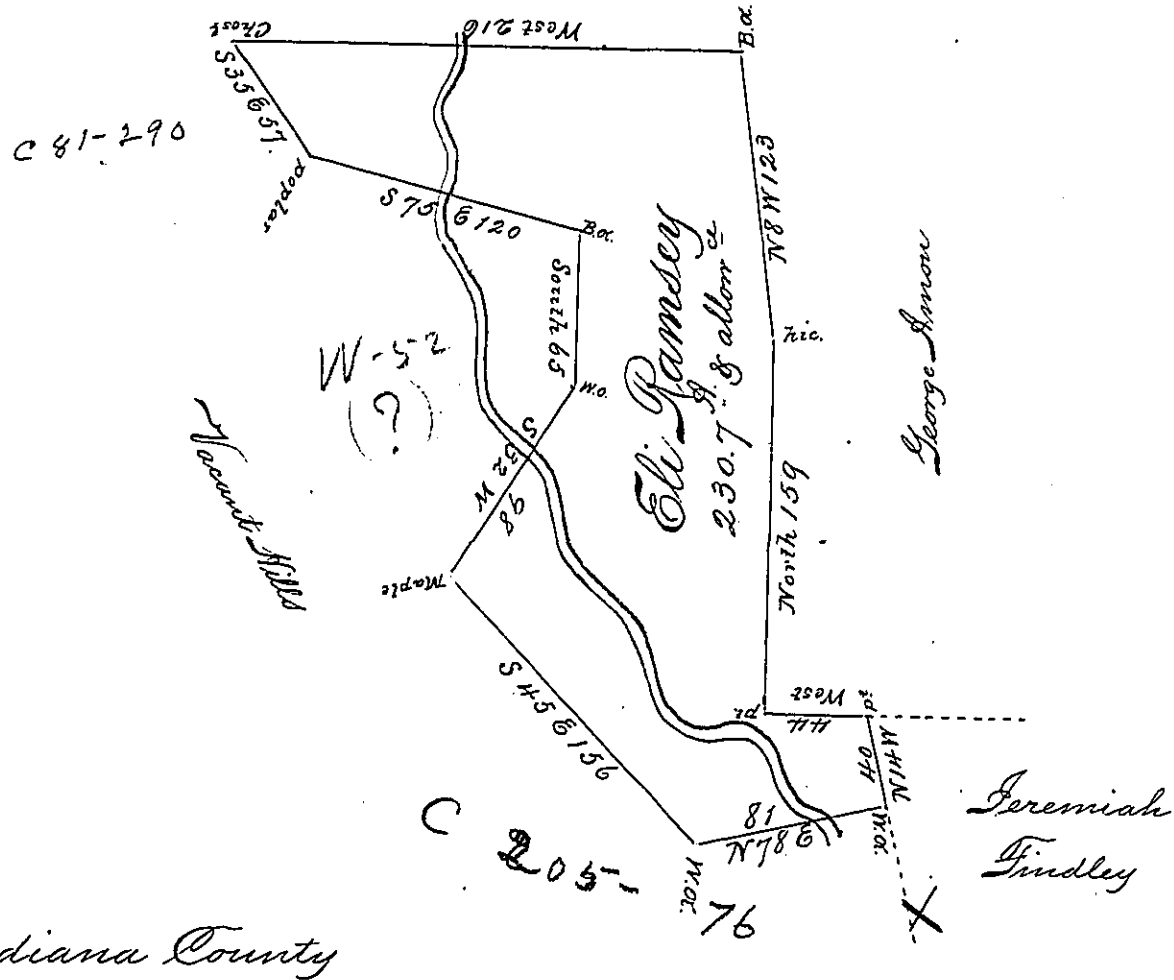

non Indiana County

Survey'd to Eli Ramsey on the 17th May 1774 The
 above Described Tract of Two hundred & thirty Acres
 & three Quarters of an Acre & the usual Allowance of
 Six p. Ct. Situate on a Fork of Brush Creek adjoining
 Jeremiah Findley in Westmoreland County
 By Warrant of the 14th August 1773
 p Joshua Elder D.S.

To John Lukens Esq: S. Genl

IN TESTIMONY that the above is a copy of the original remaining on file in the
 Department of Internal Affairs of Pennsylvania, made con-
 formably to an Act of Assembly approved the 16th day of
 February, 1833. I have hereunto set my Hand and caused
 the Seal of said Department to be affixed at Harrisburg, this
 11th day of December 1895.

James W. Patton
 Secretary of Internal Affairs.